

# harmati

## RENE

### Rene Adjustable Desk



**USA** Recommendations for the continual safe use of this product are stated on the final page of these instructions. Please retain for future reference.

**FR** Les conseils d'utilisation de ce produit sont indiqués sur la dernière page de ces instructions. Veuillez les conserver pour vous y référer si besoin.

**NL** Aanwijzingen voor veilig gebruik van dit meubel worden toegelicht op de laatste pagina van deze instructies. Bewaar deze folder goed.

**DE** Auf der letzten Seite dieser Anleitung findest du Hinweise für eine langfristig sichere Anwendung dieses Produktes. Bitte bewahre sie gut auf.

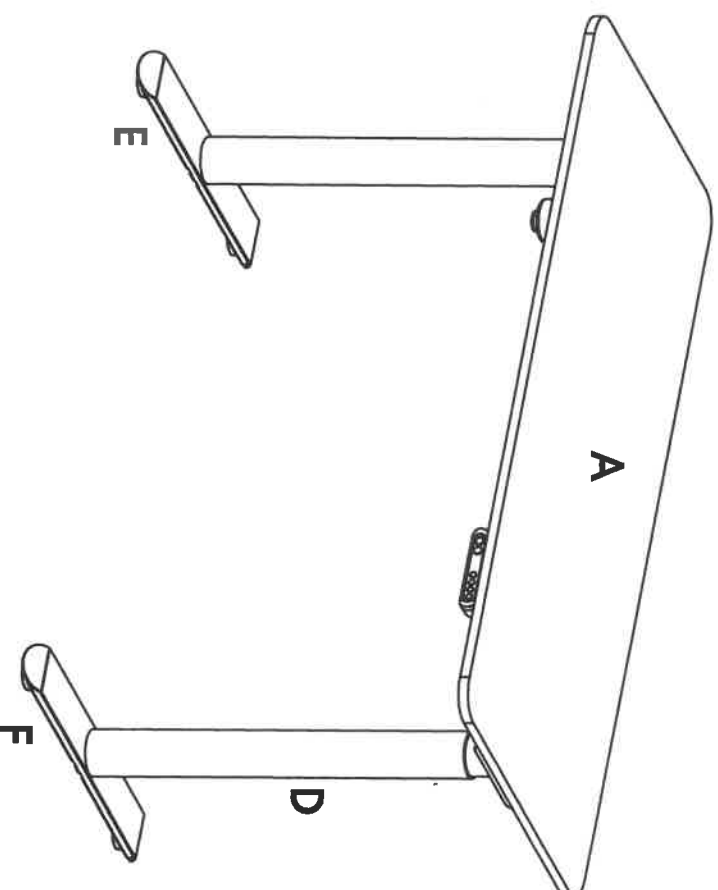

## SPECIFICATION

INPUT POWER: 120V AC, 2A, 60 Hz.

STROKE/INSTAL.: 710/480mm

MAX. LOAD: Push 800N

DUTY CYCLE: 10%, Max. 2min ON/18min OFF

RENE height adjustable desk is design to provide a healthy lifestyle to the customers. The desk could be adjusted to the the most ergonomically suitable height between 28.7"-46". This height adjustable desk are powered by electricity with an electric motor, so it is designed for use in dry work areas only. These desks are not designed to be used in environments with high humidity or dampness. Do not sit or stand on the desk, and do not move around, or lie under the desk frame.

## IMPORTANT SAFETY INSTRUCTIONS

When using a RENE height adjustable desk, basic precautions should always be followed, including the following:

Read all instructions before using the electric height adjustable desk.



**DANGER-**To reduce the risk of electric shock;

Always unplug this furnishing from the electrical outlet before cleaning.



**WARNING-** to reduce the risk of burns, fire, electric shock, or injury to persons

1. Unplug from outlet before putting on or taking off parts.
2. Close supervision is necessary when this furnishing is used by, or near children, invalids, or disabled persons.
3. Use this furnishing only for its intended use as described in these instructions. Do not use attachments not recommended by the manufacture.
4. Never operate this furnishing if it has a damage cord or plug, if it is not working properly, if it has been dropped or damaged, or dropped into water. Return the furnishing to a service center for examination and repair.
5. Keep the cord away from heated surface.

6. Never operate the furnishing with the air opening blocked. Keep the air openings free of lint, hair, and the like.
7. Never drop or insert any object into any opening.
8. Do not use outdoors.
9. Do not operate where aerosol (spray) products are being used or where oxygen is being administered.
10. To disconnect, remove plug from outlet.
11. Risk of Injury - Keep children away from extended foot support (or other similar parts)".
12. For loading always put heavier items at the bottom and not near the top in order to help prevent the possibility of the furnishing tipping over.
13. To prevent table from tipping or collapsing, make sure the desk frame is not overloaded by the weight of tabletop and objects on table. Do not exceed maximum load (including weight of desktop) of 176 lb (80Kg).

## **SAVE THESE INSTRUCTIONS CARE AND CLEANING**

1. Make sure the desk is disconnected from the power supply before cleaning. Wipe the dust on surface with dry or slight wet dishcloth, no detergent is needed.
2. If the desk is not in use for long time, remove the heavy items from the desk and the unplug the power cord from the outlet. If any cord is damaged, please contact the service to replace it.

### **FOR HOUSEHOLD USE ONLY**

## **SERVICING OF DOUBLE-INSULATED PRODUCTS**

In a double-insulated product, two systems of insulation are provided instead of grounding. No grounding means is provided on a double-insulated product, nor is a means for grounding to be added to the product. Servicing a double-insulated product requires extreme care and knowledge of the system, and is to be done only by qualified service personnel. Replacement parts for a double-insulated products must be identical to the parts they replace. A double-insulated product is marked with the words "DOUBLE INSULATION" or "DOUBLE INSULATED". The symbol (square within a square) is also able to be marked on the product.

To reduce the risk of electric shock, this furnishing has a polarized plug (one blade is wider than the other). This plug will fit in a polarized outlet only one way. If the plug does not fit fully in the outlet, reverse the plug. If it still does not fit, contact a qualified electrician to install the proper outlet. Do not change the plug in any way.

RENE electric height adjustable desk, adjust the height of the desk to your desired position.

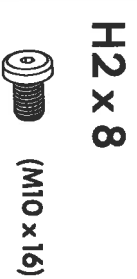
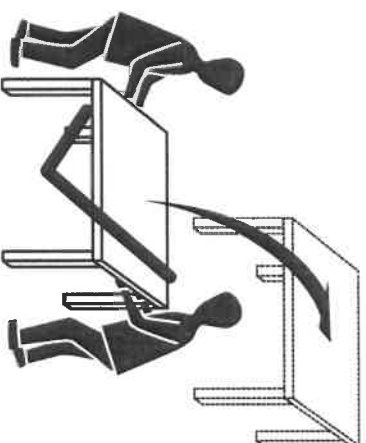
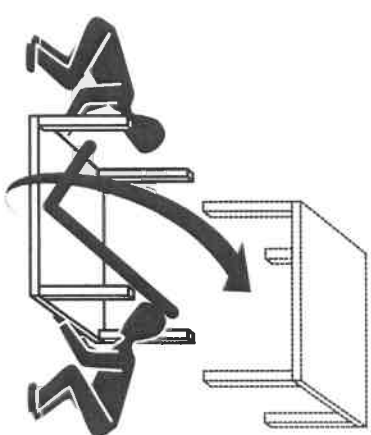
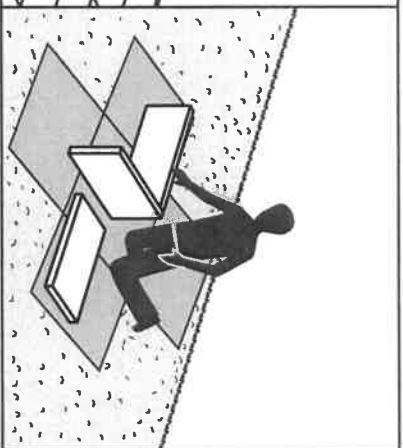
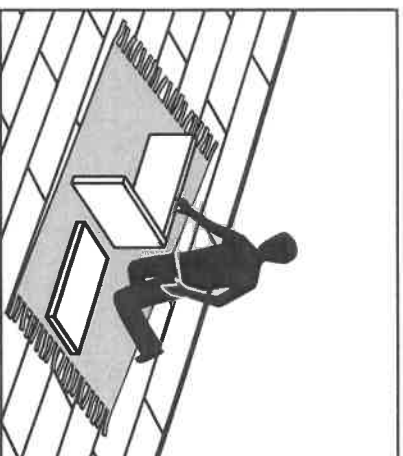
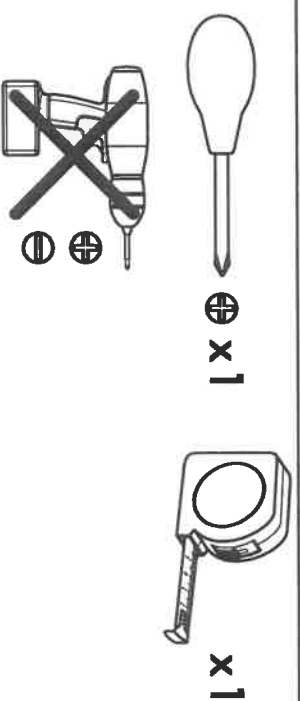
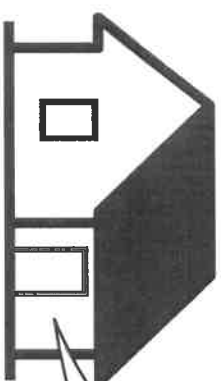
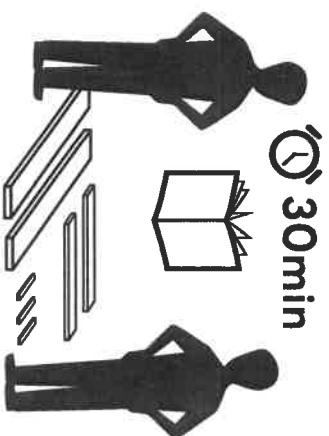

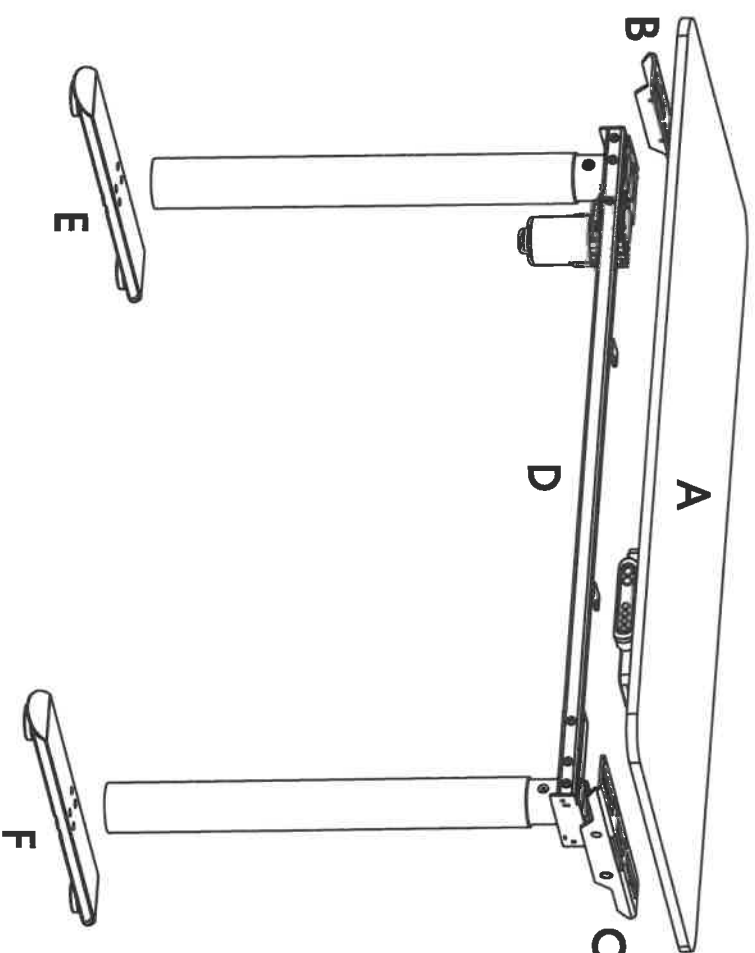

**Do not power on before assembly**  
**Reset the system after assembly**

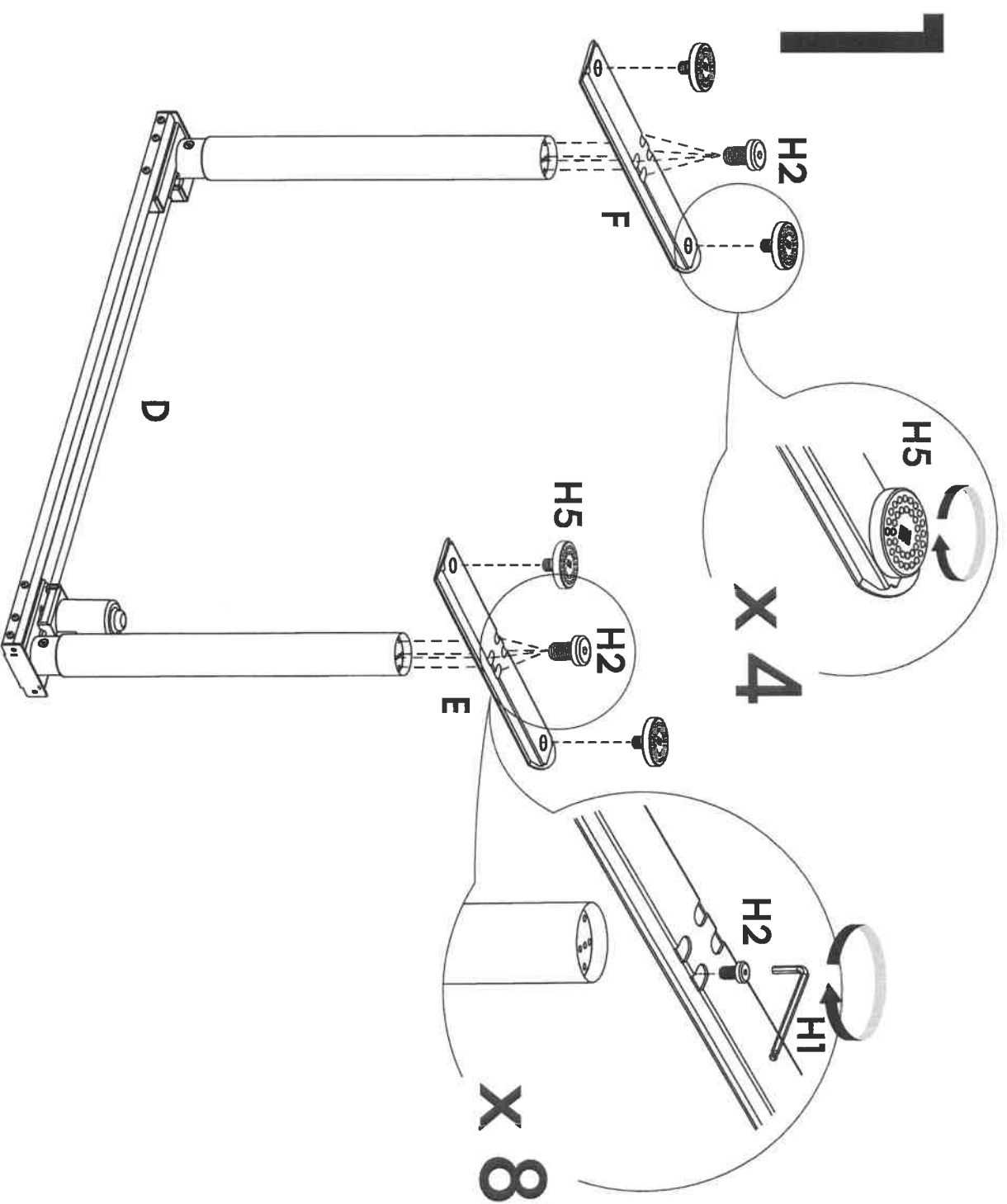

# 2

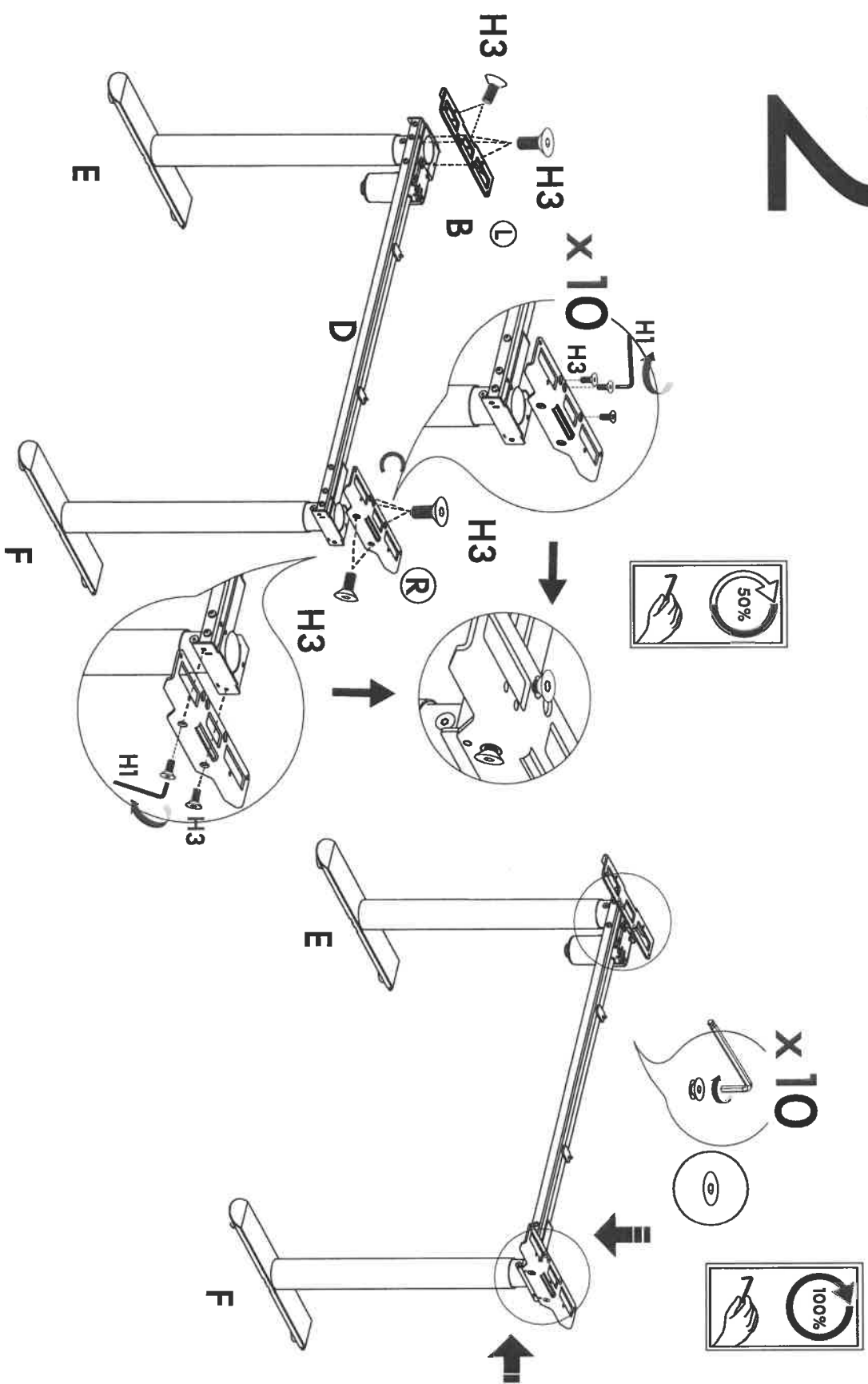



# 4

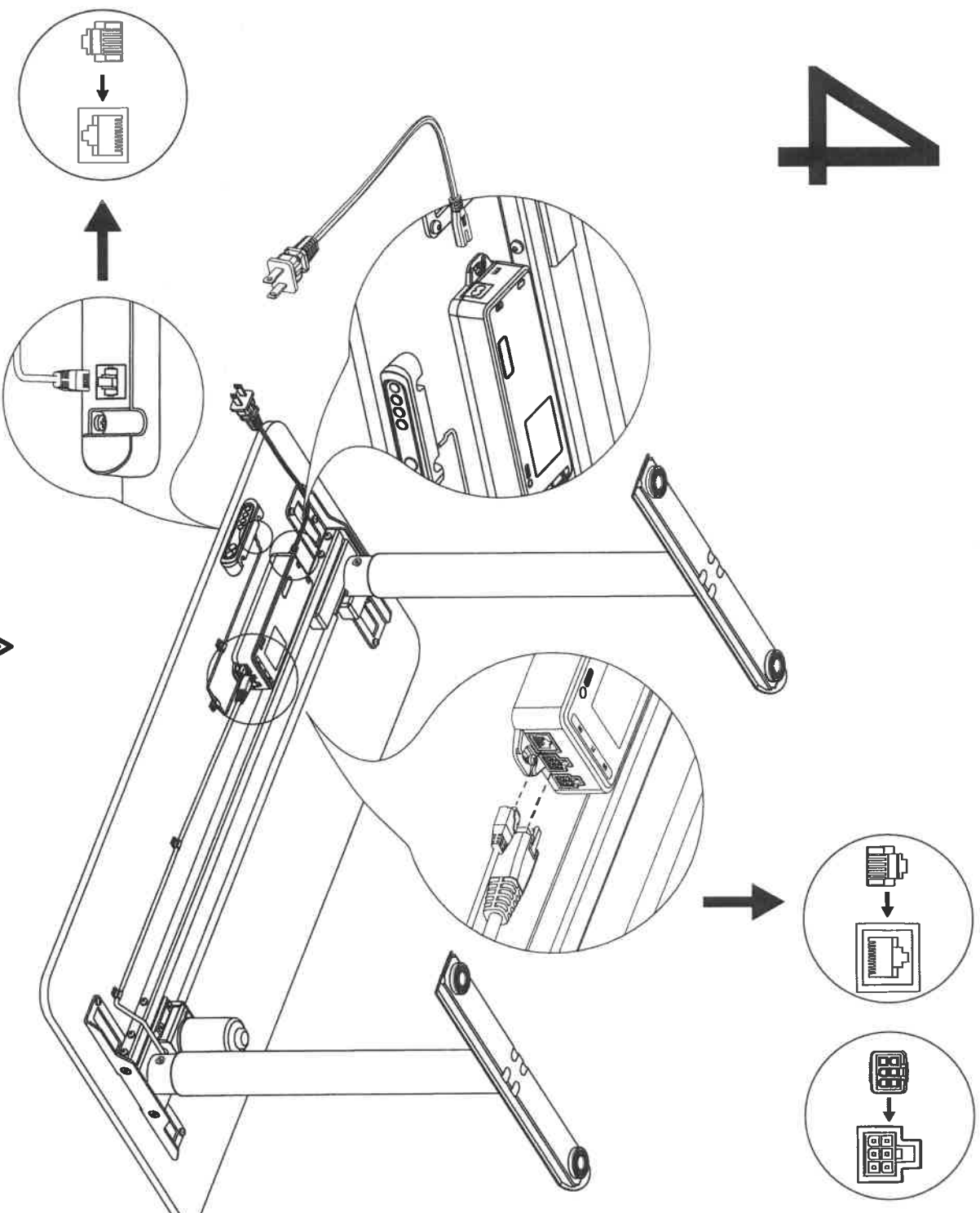

⚠  
Reset the system before using

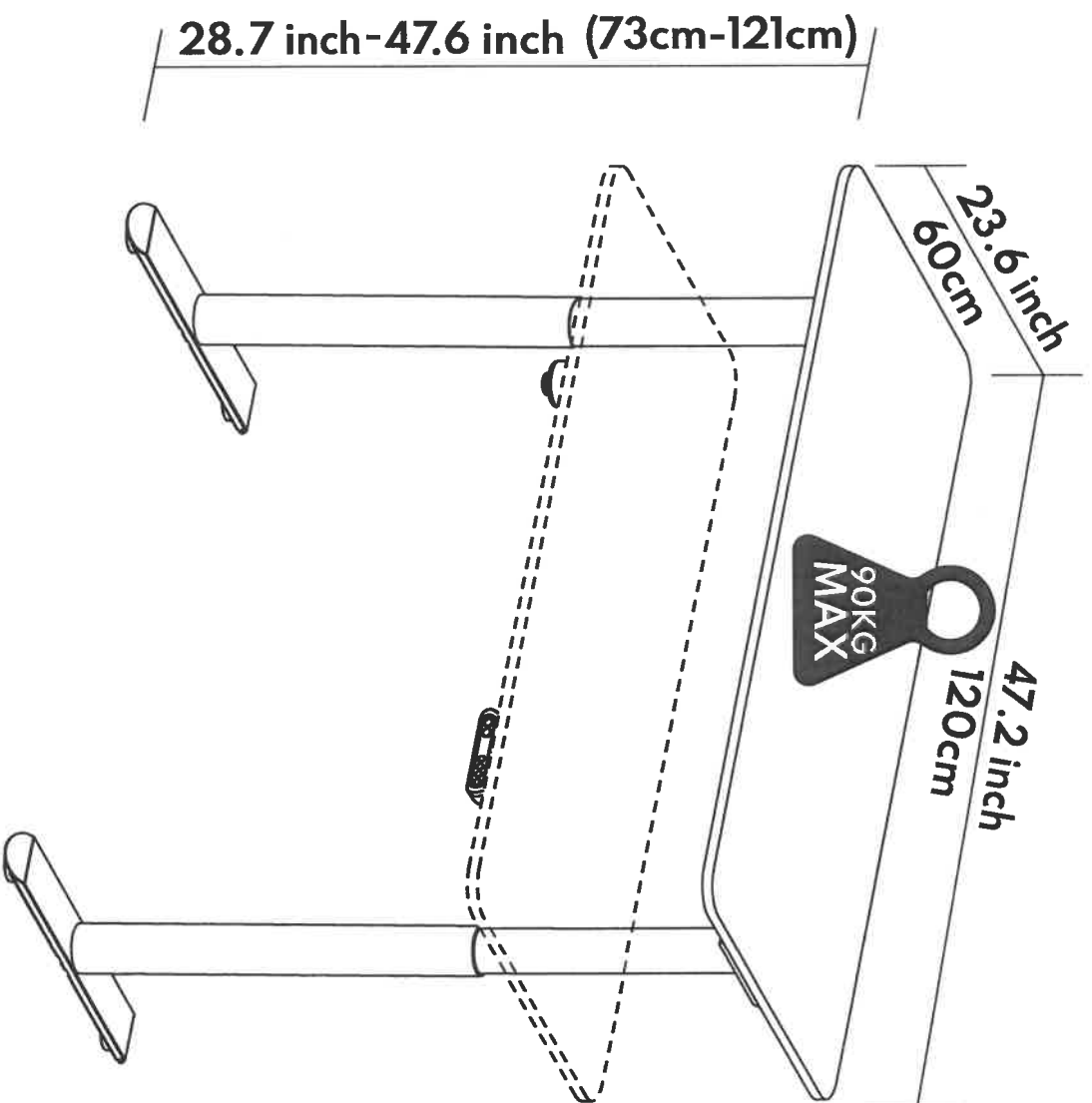

## KEYPAD INSTRUCTIONS

---

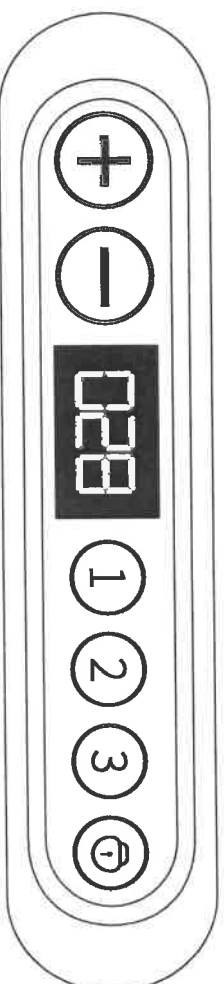

- ⊕ - UP button, used to raise the desk
- ⊖ - DOWN button, used to lower the desk
- ① - Position1, assigns the current height to number 1 on the keypad
- ② - Position2, assigns the current height to number 2 on the keypad
- ③ - Position3, assigns the current height to number 3 on the keypad
- 🔒 - Lock – Lock, multi-function. Check instructions below

## INITIAL CALIBRATION/RESET

Function: How to set the height of your desk

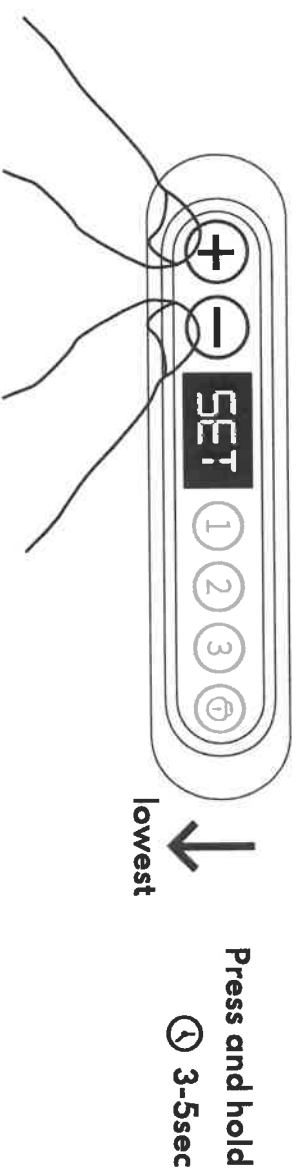

Press and hold the "+" button and the "-" button together until display reads "**SET**"



Press and hold the "+" button and the "-" button together for 3-5 seconds until the desk reaches its lowest height and the display reads "**028**". Release the "+" and "-" buttons. Resetting can now begin.

## HEIGHT ADJUSTMENT

---

Function: Adjust the desk to the desired height

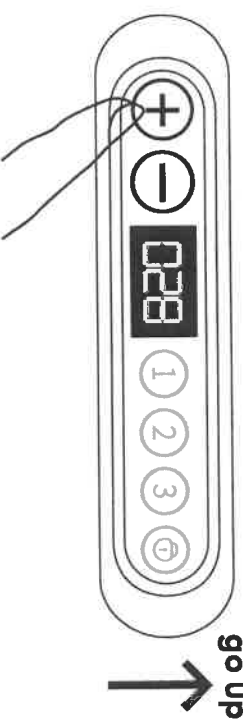

### To Raise Desk

Press and hold the “+” button, the desk should now go up. Release the button when the desk has reached your desired height per the numbers shown on display.

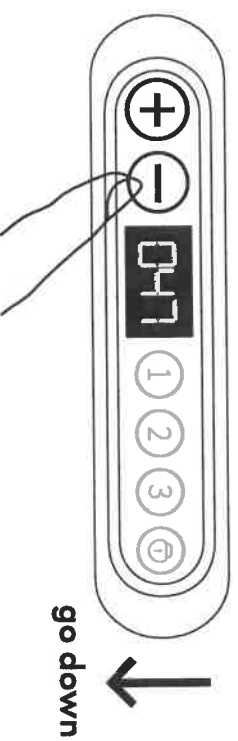

### To Lower Desk

Press and hold the “-” button, the desk should now go down. Release the button when the desk has reached your desired height per the numbers shown on display.

## MEMORY SETTING

Function: How save up to three commonly used desk heights and recall them quickly

### ① – Position 1

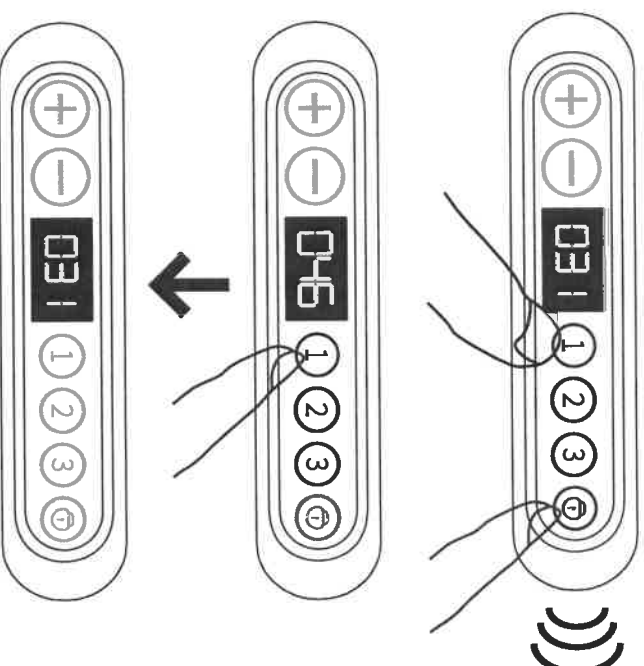

Press the “ $\oplus$ ” button or the “ $\ominus$ ” button to raise or lower the height of the desk. For instance, adjust the height to be “031”. Press the “①” button and the “ $\oplus$ ” button together and hold for 3-5 seconds. Release the buttons when you hear 3 beeps. Position 1 is now preset. To recall this height, press number 1 button to bring desk to assigned height.

## MEMORY SETTING

### ② - Position 2

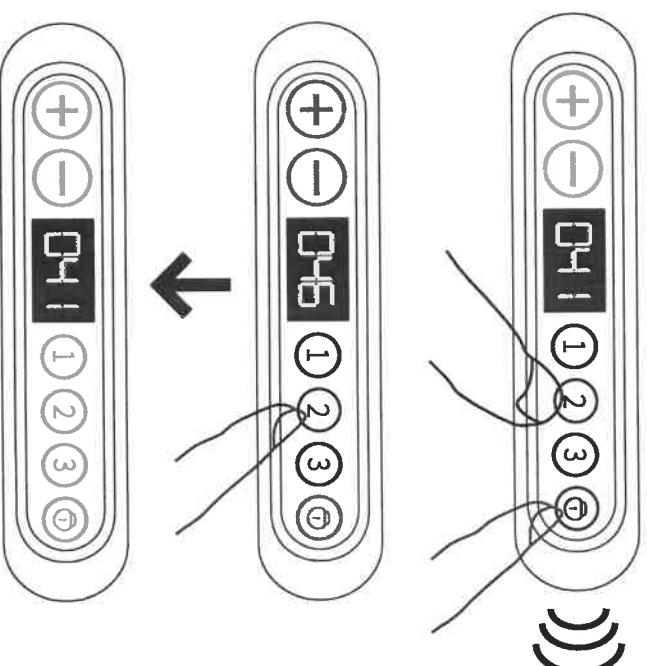

Repeat the process to set Position 1.

Press the “+” button or the “-” button to raise or lower the height of the desk. For instance, adjust the height to be “041”. Press the “②” button and the “Ⓢ” button together and hold for 3-5 seconds. Release the buttons when you hear 3 beeps. Position 2 is now preset.

To recall this height, press number 2 button to bring desk to assigned height.

## MEMORY SETTING

---

### ③ - Position 3

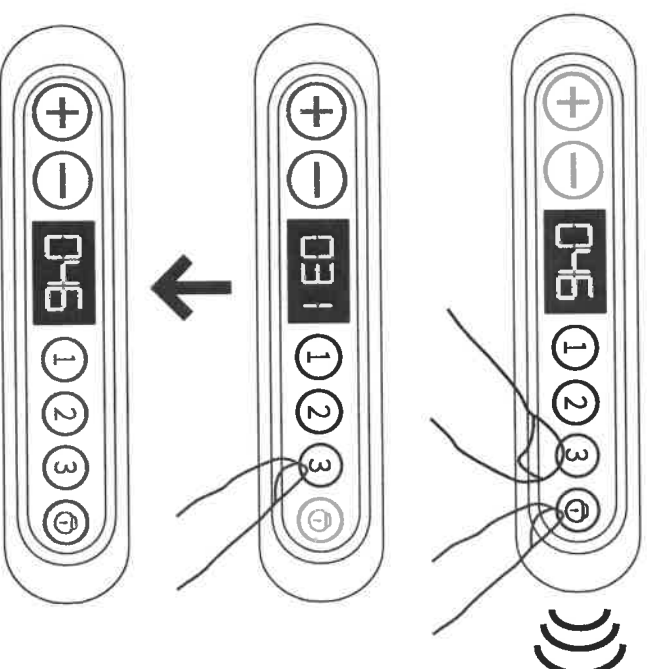

Repeat the process to set Position 1.

Press the “+” button or the “-” button to raise or lower the height of the desk. For instance, adjust the height to be “045”. Press the “③” button and the “Ⓜ” button together and hold for 3-5 seconds. Release the buttons when you hear 3 beeps. Position 3 is now preset.

To recall this height, press number 3 button to bring desk to assigned height.

## MEMORY SETTING

---

### Position suggestions

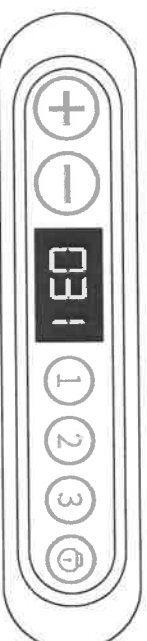

Position 1: “031”, which is 31’ high or “076”, which is 76cm high

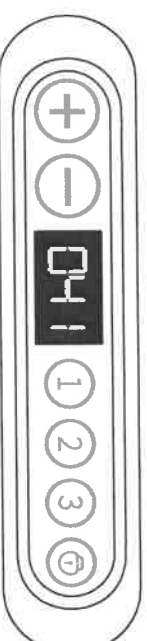

Position 2: “041”, which is 41’ high or “106”, which is 106cm high

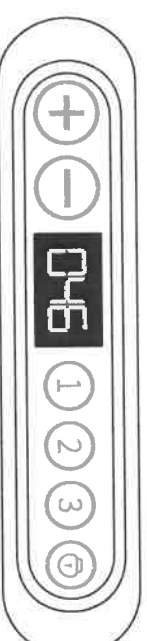

Position 3: “046”, which is 46’ high or “119”, which is 119cm high

## MINIMUM & MAXIMUM HEIGHT SETTINGS

Function: The desk stops moving when it reaches the maximum or minimum set height

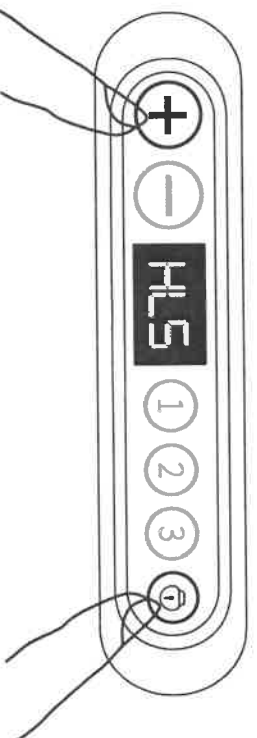

Maximum desk height setting

Raise the desk to the desired maximum height. Press the “+” button and the “Ⓟ” button together and hold for 3-5 seconds. Release the buttons when the display shows “**H.L.S**”. The maximum height is now set.

## MINIMUM & MAXIMUM HEIGHT SETTINGS

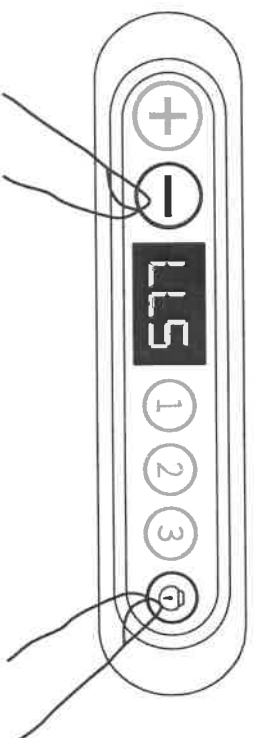

### Minimum desk height setting

Lower the desk to the desired minimum height. Press the “**⊖**” button and the “**Ⓛ**” button together and hold for 3-5 seconds. Release the buttons when the display shows “**LL5**”. The minimum height is now set.

## MINIMUM & MAXIMUM HEIGHT SETTINGS

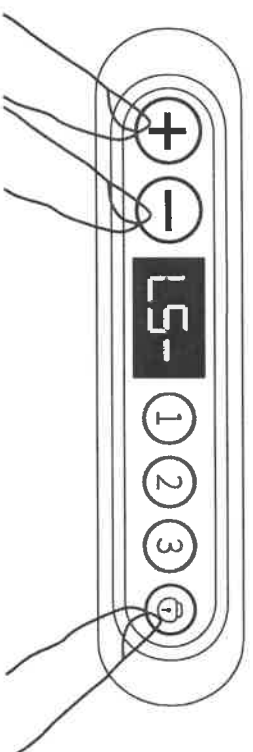

Remove the Maximum/Minimum Height Setting

Press the “ $\oplus$ ” “ $\ominus$ ” and “ $\oplus$ ” buttons together and hold for 3-5 seconds. Release the buttons when the display shows “**LS-**”. The maximum and minimum limits are now removed.

## LOCK / UNLOCK

---

Function: Lock the desk at the desired height. The desk height will remain unchanged until you unlock it

Lock

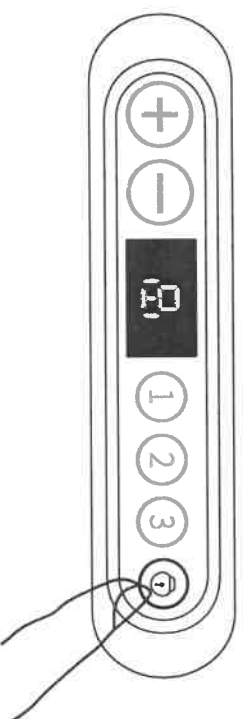

Raise or lower the desk to the desired height. Press the “Ⓢ” button for 3-5 seconds. The desk is locked when the display shows “121”



Unlock

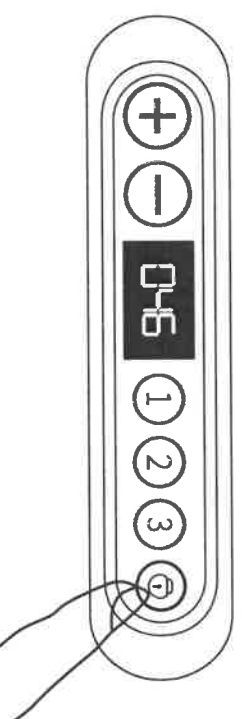

Press the “Ⓢ” button for 3-5 seconds. The desk is unlocked when the display shows a number. For instance “116”

## DISPLAY UNITS

---

Function: Change the numeric display to show heights in either inches or centimeters

**R21** stands for “cm”, **R22** stands for “inch”

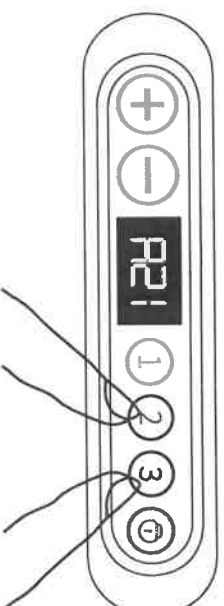

### CM

Press the “2” button and the “3” button together and hold for 3-5 seconds. When the display shows “**R21**”, the height unit is set to cm.

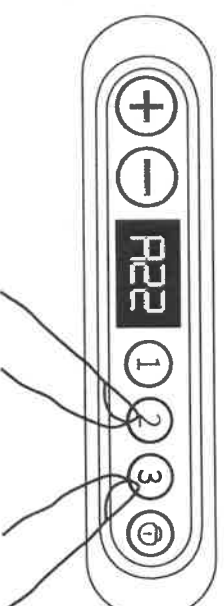

### INCHES

Press the “2” button and the “3” button together and hold for 3-5 seconds. When the display shows “**R22**”, the height unit is set to inches.

## **TROUBLESHOOTING**

---

The following table describes errors and issues that you may encounter when using Harmati's Rene Adjustable Desk. Please email us at [support@harmati.com](mailto:support@harmati.com) if your problem is not included on the list or if the issue persists

<b>Issue</b>	<b>Solution</b>
<b>ERROR CODE - ER2</b>	<b>Why:</b> Constant running of the system for 4 minutes may cause the problem
	<b>Solution:</b> Let the system cool down for 20 minutes and try to start it again
	<b>Why:</b> Accidental power supply failure may cause the problem
<b>ERROR CODE - ER3</b>	<b>Solution:</b> Restore power and reset the system
	1. Check to make sure all the cables are secure and plugged in
	2. Contact Harmati for support
No response when pressing and holding buttons	1. Check if the load weighs more than 200lbs or 90kg
	2. Contact Harmati for support
Motor does not work properly	1. Start the reset process
	2. Contact Harmati for support
Can raise but cannot lower desk	1. Check if the load weighs more than 200lbs or 90kg
	2. Contact Harmati for support
Desk surface is tilting or sliding down	1. Check if the load weighs more than 200lbs or 90kg
	2. Contact Harmati for support
Very frequent automatic resets	1. Check if the load weighs more than 200lbs or 90kg
	2. Contact Harmati for support